

Evaluation Form

2022

**City of Barrie,
Ontario**



Growing Great Places Together
Cultivons ensemble de beaux espaces

2022 Evaluation Form



2022 Evaluation Form



Community: City of Barrie
 Province: Ontario
 Category: Circle of Excellence - Evaluated

**CiB recognizes efforts to mitigate and adapt to climate change which is reflected in several criteria including:
 Environmental Action; Preservation of Natural Heritage; Tree Management and Landscape**

Community Appearance	134.50	/	150.00
Environmental Action	135.50	/	150.00
Heritage Conservation	132.00	/	150.00
Tree Management	160.00	/	175.00
Landscape	179.50	/	200.00
Plant and Floral Displays	162.00	/	175.00
	Total		903.50 / 1000.00

Percentage: 90.35%

Bloom rating: 5 Blooms - Gold

Bloom rating: Provincial, National and International Participants
 Up to 55%: 1 bloom. 56% to 63%: 2 blooms. 64% to 72%: 3 blooms 73% to 81%: 4 blooms. >82%: 5 blooms.

Bloom Levels: National Edition and International Challenge, for evaluated communities only.
 82 to 83.9%: 5 Blooms. 84 to 86.9%: 5 Blooms (Bronze). 87 to 89.9%: 5 Blooms (Silver). 90% and over: 5 Blooms Gold

Mention: Gypsy Moth Awareness Program

Representative (s) of Community

Name: Mona Boyd Function: Parks Horticulture Foreperson
 Name: Kyle Stasiuk Function: Gardener at City of Barrie
 Name: _____ Function: _____

Judges

Name: Martin Quinn Name: Anthony O'Neill

Evaluation date: July 27/28 – 2022

2022 Evaluation Form

IMPORTANT NOTES:

Evaluation is adjusted to the climate and environmental conditions of the community.

Evaluation is also adjusted to match the capacity of a community population to the achievements in all criteria – i.e. evaluate what they do (achieve) with what they have (population/ resources).

Some aspects of the evaluation might not be applicable: scoring will be prorated.

The score will vary from the previous year based on the facts that the evaluation form is subject to modifications each year and that the scores are based on the perception of the current judges.

SECTORS OF EVALUATION

Municipal:

- Municipal properties, parks and green spaces, streets, streetscapes
- Properties owned and run by municipality such as museums, historical sites

Business and Institutions:

Properties owned and managed by

- **Business:** commercial sector, shopping centres, Business Improvement Areas (BIA), industrial parks, manufacturing plants
- **Institutions:** schools, universities, churches, hospitals, service and community organization buildings (such as YMCA, Legion), private museums, Government and Crown Corporations buildings (such as Canada Post, provincial and federal parks, etc.)
- **Tourism bureaus and Chamber of Commerce offices**
- **Farms:** in rural communities, farms can be considered in this section

Residential:

- Citizens and citizen groups acting within their own properties
- Residential property owners, rate payer groups including condos and co-ops

Community Involvement:

The principle of community involvement is so fundamental to the program that it is considered in each segment of the evaluation.

- Individuals, community organizations, citizen groups (includes youth programs) – all contributing to various aspects of community improvement, including municipal spaces maintained through the efforts of volunteers and community
- Organized clubs such as horticultural societies, garden clubs, community associations, school groups
- Service clubs such as Rotary, Lions, Optimist
- Participation (financial and/or in-kind or employee participation) by the municipality, businesses and institutions.

2022 Evaluation Form

GENERAL COMMENTS AND SUGGESTIONS

Communities in Bloom would like to thank Barrie for showing us what makes Barrie such a wonderful community. Having CiB judge the community without competing is a testament to the value Barrie places on continuous improvement.

Maintaining the city as Barrie has and engaging with vision for the future has allowed Barrie to receive a **5 Blooms - Gold rating**. Congratulations and well deserved!

Mona you are such an asset to your community for your passion of horticulture and your city, we applaud you.

Barrie is a growing city that has an exciting future ahead. Learning what we did it is obvious that the Parks and Forest division of the town is working passionately on developing the town as a healthy place to live.

Your work in the environmental field, at your land fill, composting and recycling area is world class and will be emulated as word spreads. Wow, congratulations!!

The aerial overview of the City really allowed us to see the city as we rarely have the chance to do. Congratulations on your approach to development which includes the ability to be able to connect people with nature.

CiB judges greatly appreciated the presentation on transport plans. Great job so far, on an ambitious approach.

Thanks for the exuberant hospitality. It is wonderful to see a comprehensive approach to urban planning, that helps position Canada a great country in which to live because of places like Barrie.

We are thrilled you find value in CiB, and we look forward to working with you in the future as we continue to grow great places together!

Martin Quinn & Anthony O'Neill
CiB National Judges, 2022

2022 Evaluation Form

COMMUNITY APPEARANCE		
<p>Community appearance reflects an overall effort by the municipality, businesses, institutions and the residents throughout the community to create great first impressions and a sense that there is continuous attention and upkeep to critical elements of a community that benefit quality of life and economic vitality Elements for evaluation are: parks and green spaces, medians, boulevards, sidewalks, streets; municipal, commercial, institutional and residential properties; ditches, road shoulders, vacant lots, signs and buildings; weed control, litter clean-up (including cigarette butts and gum), graffiti prevention/removal and vandalism deterrent programs.</p>		
	Max	Actual
Municipal		
Gateway Impressions First impressions of the community including gateway/entrance landscape treatments	10	8.5
Overall Impressions Order, cleanliness, curb appeal and first impressions	10	9
Anti-litter/Graffiti Prevention and Removal Community anti-litter/graffiti awareness programs	10	9
Regulations Effective bylaws, programs and policies and enforcement; litter control, private property maintenance by-laws, vandalism, graffiti prevention and eradication, graffiti removal kits to residents	10	9
Asset Appearance Includes public green infrastructure: parks, streetscapes (sidewalks, planters, urban signage and furniture such as benches, litter and recycling containers etc.)	10	9
Municipal Properties Appearance Visual appeal and condition of municipal buildings and municipal owned properties	10	9
Business & Institutions		
Overall Impressions Curb appeal, order, and cleanliness	15	13.5
Site Conditions Condition of buildings (exterior maintenance), grounds, sidewalks and parking lots	15	13.5
Furniture/Amenities Appearance Condition of urban furniture: benches, litter and recycling containers	5	4
Residential		
Overall Impressions Curb Appeal, order and cleanliness	20	19
Property Conditions Condition of buildings, grounds and yards	15	14
Community Involvement		
Public Participation In community, neighbourhood or individual streets, clean-up programs, activities and annual maintenance (including promotion, organization, innovations involving youth and seniors, etc.)	10	8.5
Community Support Financial and/or in-kind or participation by the municipality, businesses service groups, and institutions for community clean-up programs.	10	8.5
Community Appearance Total	150.00	134.50

2022 Evaluation Form

COMMUNITY APPEARANCE

Observations:

Barrie, you have clean and organized entry roads into the city that includes a well landscaped community welcome sign on highway 400, that is a taste of what to expect as you enter your beautiful community.

You have an exciting multi-functional city with connections to the water and land, that many communities wish for.

Your emphasis on making Barrie an enjoyable city for its citizens and tourists is obviously a priority, and congratulations on making Barrie an attractive destination.

Your downtown is vibrant and so brilliantly revitalized, utilizing old and new in harmony.

Nature, by design is accessible by all, in the way you weave development and nature into one. Good work!

Recommendations

Upgrade the landscaping around sign coming in from the local airport by pruning around it and adding shrubs or florals would be an asset.

City Council might review its Property Standards By-law regarding unkept properties and consider taking a more proactive approach than the complaint method.

Work with small businesses, especially on the outskirts of the City, to install foundation plantings around their properties. Explaining how with their help in sequestering carbon while helping mitigate the effects of climate change may encourage them.

Celebrate their efforts and encourage them to showcase their results. consider creating a public competition among the businesses, which will ultimately attract more encourage customers and grow public trust.

2022 Evaluation Form

ENVIRONMENTAL ACTION		
<p>Environmental action pertains to the impact of human activities on the environment and the subsequent efforts and achievements of the community with respect to: environmental stewardship, policies, by-laws, programs and best practices for waste reduction and landfill diversion, composting sites, landfill sites, hazardous waste collections, water conservation, energy conservation, and activities under the guiding principles of sustainable development pertaining to green spaces.</p>		
	Max	Actual
Municipal		
Sustainable Development Strategies Policies, programs, guidelines, long-term planning/vision; effective bylaws/policies and their enforcement; and public education programs and activities. This includes activities such as: the creation of Active Transportation networks, fleet management, and recognition of the importance of biodiversity to mitigate and adapt to climate change.	20	19
Waste Reduction Reduction of waste going to landfill and results (3-R: reduce, reuse and recycle), municipal composting programs, including activities such as composting sites, yard waste collections, plastics reduction programs, mulching of wood debris (Christmas trees, hedge trimmings, etc.) and reclamation of cut trees. Handling of hazardous waste including e-waste collection and reuse of compost material. Officially mandating the greening of public events such as on-site recycling bins, biodegradable drink containers, food service dishes, utensils, etc to minimize the use of plastic.	20	20
Water Conservation Use-reduction programs such as promotions, efficient irrigation, use of non-potable water, water restriction policies	15	13.5
Energy Conservation Programs such as alternate forms of energy (ex. geothermal, biomass, wind, solar) and initiatives such as: energy-efficient appliances, shielding for night skies, efficient street lighting	15	13.5
Environmental Initiatives, Innovations and Actions		
<ul style="list-style-type: none"> - Development and expansion of sustainable mobility and active transportation networks such as bike lanes, multi-use commuter pathways, and recreational trails - Horticultural practices such as planned biodiversity, green roofs, green walls, green lanes, living fences, buffer zones; re-use of sites; engineered wetlands, bioswales, permeable surfaces and rainwater management - Brownfield redevelopment, remediation, land reclamation - Air quality programs such as alternate energy sources, sustainable design of facilities, sustainable fleet management, reduction of greenhouse gas emission (carbon reduction), anti-idling by-laws. 	10	9
Business & Institutions		
Participation in The Environmental Effort Waste management (reduce, reuse and recycle), water conservation, energy conservation and audits (fleet management, electric conservation), brownfield management	10	8.5
Corporate Environmental Initiatives and Action Innovation/stewardship, initiatives, activities (for example: environmental clean-up activities, plastic reduction) carbon emissions, green roofs	10	8.5
Residential		
Participation in Environmental Initiatives 3-R (reduce, reuse and recycle), composting	10	9
Water & Energy Conservation Practices such as water use reduction, rainwater collection and rain gardens, alternate forms of energy, thermostat reduction	15	13.5
Community Involvement		
Public Participation – Civil Action Participation in public forums and policy development on environmental issues, such as climate change adaptation and mitigation	5	4
Public Participation in Activities Community (including children/youth), neighbourhood or individual street environmental activities and programs (including promotion, organization and evidence of taking ownership, etc.)	10	8.5
Community Support Financial and/or in-kind or participation by the municipality, businesses and institutions in public environmental activities and programs	10	8.5
Environmental Action Total	150.00	135.50

2022 Evaluation Form

ENVIRONMENTAL ACTION

Observations:

Barrie transit with its on-demand system, and all the initiatives using technology and innovation to improve local transportation is excellent, and we look forward to your new transit station as it comes online.

Your focus on improving diversion rates is forward thinking and bodes well for the future

We can see a growing culture of complete environmental awareness and concern developing within the city and adaptive planning is under way. Congratulations, you are ahead of the curve.

The City has reached out to all sectors and achieved their buy-in of municipal programs. Your educational and promotional programs are working well.

Congratulations, Barrie on being a Birds, Butterflies and Bees Friendly City. You are providing for a happier Barrie!

We were so very impressed with your work at your land fill redevelopment, composting and recycling yard that is world class and will be emulated as word spreads. Well done!

Recommendations:

Explore ways to capture grey water from sports field for watering plantings and investigate other opportunities. <https://builderbaron.com/?s=Storm+water+retention+ponds>

Discuss and research the value of permeable surfaces such a permeable paver, versus concrete for landscape developments.

Become a leader in Biochar production in Canada. Find grants to develop a processing plant based on turning dead ash affected by EAB into carbon sequestering planting media that would improve the health of trees planted in the urban forest. You might think of contacting Sabine Bouchard at College Boreal in Sudbury, as she is doing research in this area.

Think about assessing and valuing the Little Lake property owned by City and include it on the City's financial Balance Sheet.

A study conducted to review the green algae forming along the bay would reassure residents and the Council that appropriate measures are being taken based on recommendations. Inaction is a risk.

Developing an Environmental Masterplan is critical as climate change becomes our new reality.

2022 Evaluation Form

HERITAGE CONSERVATION		
<p>Heritage conservation includes efforts to preserve and protect both natural and cultural heritage within the community. Preservation of natural heritage pertains to policies, plans and actions concerning all elements of biodiversity including flora and fauna ecosystems and associated geological structures and formations. Cultural conservation represents the “persona” of a community and refers to the heritage that helps define the community including the legacy of tangible (built/hard assets) elements such as heritage buildings, monuments, memorials, cemeteries, artifacts, museums and intangible elements such as traditions, customs, festivals and celebrations. The participation of groups such as historical societies, traditional cultural groups, and conservation groups is considered.</p>		
	Max	Actual
Municipal		
Natural Heritage Plans Management and preservation policies, plans, programs and initiatives: including eco systems, eco parks, trail networks, grasslands, naturalization, wetlands, urban agriculture/farming, wildlife and wildlife corridors, protection of sensitive habitats, species at risk and support for at risk pollinators.	20	19
Natural Heritage Promotion Management and promotion of natural heritage (through communications, information and support programs, economic development/tourism) including year-around activities and programs for education and use of natural heritage sites (including trail networks) for and by the public.	15	14
Cultural Heritage Plans Policies, by-laws, plans, and preservation initiatives for heritage buildings, cemeteries, artifacts, museums, monuments, heritage trees and gardens, including their integration with streetscapes and landscape	15	13
Cultural Heritage Activities Initiatives throughout the year including festivals and celebrations along with preservation of traditions and customs	15	13.5
Business & Institutions		
Natural Heritage Assets Conservation, restoration and integration of natural heritage, including eco parks, conservation areas, trails, heritage gardens, trees and landscapes.	10	8
Cultural Heritage Assets Conservation, restoration and reuse of heritage buildings and artifacts including their integration with the built/hard?, streetscapes and green landscapes	10	8.5
Residential		
Cultural Heritage Initiatives Conservation/restoration and reuse of heritage buildings and artifacts on residential lands	10	7.5
Community Involvement		
Natural Heritage Public Participation Participation in community (including children/youth), neighbourhood or individual natural heritage programs and initiatives including developing policies and plans, site improvements (including trails, eco parks, reforestation and management, maintenance, conservation and education initiatives	20	17.5
Natural Heritage – Community Support Financial and/or in-kind or participation by the municipality, businesses and institutions (including environmental groups) in community-initiated natural heritage activities and programs	10	8.5
Cultural Heritage - Public Participation Participation in community (including children/youth), neighbourhood or individual cultural heritage programs including year-round heritage community events/activities, festivals and celebrations along with preservation of traditions and customs	15	13.5
+Cultural Heritage - Community Support Financial and/or in-kind or participation by the municipality, businesses and institutions (including historical societies) in community-initiated cultural heritage activities and programs.	10	9
Heritage Conservation Total	150.00	132.00

2022 Evaluation Form

HERITAGE CONSERVATION

Observations:

Although Barrie is a young city, you have a large portfolio of natural and cultural heritage within your boundaries.

In the older sections of town, we observed that buildings were being well-maintained and that the City is in the midst of major upgrades to the area's infrastructure.

Through the Heritage Registry Barrie does a good job of informing the residents and tourists about its built heritage.

Your signage throughout the downtown pertaining to historic buildings is very significant and informative.

Your professional approach to Geese control is to a high standard, and to be commended.

Recommendations:

A Natural Asset Inventory identifying, assessing, and evaluating elements of natural history would add substantially to an asset management plan. <https://greenmunicipalfund.ca/case-studies/measuring-value-natural-assets>

Areas of focus would include sections of natural areas adjacent to subdivision developments that have been secured by the city.

Updating and reviewing your Tree Inventory and assessing a value to chosen tree areas would make politicians and the public more aware of their value. It would also help with regular maintenance planning by Parks staff.

Closely monitor the non-native ornamental grass located at Wilkins Beach. Implement a plan to control and eradicate this invasive species (*miscanthus sacchariflorus*).

Explore the many avenues to celebrate your indigenous culture.

An interactive walking tour using QR codes to help identify your Heritage Buildings, Trees, and Natural Heritage is a good way to help visitors explore your City.

2022 Evaluation Form

TREE MANAGEMENT		
Woodlands, Canopy Management, Urban and Rural Forestry includes the efforts of the municipality, businesses, institutions and residents with regards to written policies, by-laws, standards for tree management protection (selection, planting, and maintenance), long and short-term management plans, tree replacement policies, pollinator-friendly tree selection, tree inventory including heritage, memorial, and commemorative trees, and Integrated Pest Management (IPM) programs.		
	Max	Actual
Municipal		
Overall Impression Overall impact, benefit and first impression of the urban forest	10	9
Strategic Plans Policies, regulations and tree by-laws, tree protection and planting on public and private lands	15	14.5
Urban Forestry Plan Plan, design and inventory management including integration with overall green infrastructure landscape plan, and measures to preserve, protect, manage and expand overall tree inventory, including woodlots and managed forests	20	19.5
Plan of Action Procurement, species diversity (including native trees), selection of hardy and pollinator habitat tree species, recommended tree list and tree planting standards.	10	9
Integrated Pest Management (IPM) / Plant HealthCare (PHC): plan of action for invasive pest detection and control, information on current infestations and diseases	10	9
Public Information Programs Provides information on good planting techniques, best practices and maintenance programs	15	14.5
Maintenance Quality Best practices with demonstrated results	10	9
Qualified Resources Qualified personnel (including seasonal staff and/or qualified experienced contractors) and/or in place training programs	5	4.5
Business & Institutions		
Tree Inventory Contribution to expanding overall tree inventory and canopy, management of hedgerows and forests, with consideration of design and diversity including native and hardy species of trees, on properties owned by businesses and institutions.	15	13.5
Maintenance Quality Programs, best practices with demonstrated results: watering, pruning, IPM	10	8.5
Residential		
Tree Planting Contribution to expanding overall tree inventory, with consideration of design and diversity including native and hardy species of trees on residential properties	15	13.5
Maintenance Quality Best practices with demonstrated results	10	9
Community Involvement		
Public Participation Participation (including children/youth) in tree planting and conservation programs such as Green Streets Canada, Arbor Day, Maple Leaf Day, and other tree planting and maintenance programs and activities on public lands (including promotion, organization etc.)	20	18
Community Support Financial and/or in-kind or participation or promotion by the municipality, businesses and institutions for community tree planting and conservation programs on public lands	10	8.5
Tree Management Total	175.00	160.00

2022 Evaluation Form

TREE MANAGEMENT

Observations:

Emerald Ash Borer has significantly damaged your urban forest and many more trees need to be removed. A monumental task.

Your program of education regarding the impact of Gypsy Moth (Spongy Moth) is to be commended and copied. It has achieved good public uptake and understanding, as seen on our tour.

What forward thinking to see trials with Silva culture cells for your street tree planting. Fantastic!

The provision of free trees for new construction homes sets a good standard.

We were impressed with your tree canopy at large public and sport facilities. A significant step for climate change.

Recommendations:

Increasing of the number of tree species planted within Barrie would be beneficial moving forward. Consider Beech, Hemlock, Russian Olive, original species of Acer to mix with cultivars.

As mentioned earlier, research the opportunities associated with creating Bio-Char with the dead Ash trees.

Review opportunities for having tree planting events that coincide with May Day, Earth Day, Arbor Day, Canada Day, the birth of a child, High School Graduations. Any excuse to plant a tree!

Think of creating a container tree planting program for downtown city core, to help reduce concrete heat islands, and to be used to decorate for special events

We hope you will expand your brilliant educational programming.

2022 Evaluation Form

LANDSCAPE		
<p>Landscape includes planning, design, construction and maintenance of parks, green spaces and cemeteries suitable for the intended use and location on a year-round basis. Elements for evaluation include: native and introduced materials; biodiversity, materials and constructed elements; appropriate integration of hard surfaces and art elements, use of turf and groundcovers. Landscape design should harmonize the interests of all sectors of the community and provide safe and secure public spaces. Standards of execution and maintenance should demonstrate best practices, including quality of naturalization, use of groundcovers and wildflowers along with turf management.</p>		
	Max	Actual
Municipal		
Sustainable Designs – Soft Landscape Sustainable designs: energy efficient, use of green materials, naturalization, xeriscaping, suitable plant varieties (including pollinator friendly), traffic calming, bank stabilization	15	14
Sustainable Designs - Hard Landscape Urban and civic design standards for streetscape and public places including considerations for public safety: flags, banners, public art, fountains, site furnishings, signage including wayfinding and directional, seasonal design and décor, walkways and paving materials including use of artificial turf and its protocols	15	14
Landscape Plan Integrated and implemented throughout the municipality	10	9
Landscape Management Programs Integrated Pest Management (IPM), Plant Health Care (PHC), alternative solutions to diseases and infestations when appropriate, Invasive Species Management, increased naturalization and adapted maintenance programs	10	9
Landscape Maintenance Policies, Standards, Best Practices and Programs including irrigation water management	10	9
Landscape Quality Landscape maintained to appropriate standards, specs and best practices, as an example as shown in the Canadian Landscape Standards	5	4.5
Qualified Resources Qualified personnel (including seasonal staff) and/or in place training programs and/or qualified experienced contractors	10	9.5
Year-round use Demonstrated year-round opportunities and programs for education and people being active and using parks and green spaces (urban agriculture, community gardens, parks and recreation programs and accessible public washrooms)	10	9
Business & Institutions		
Sustainable Designs: energy efficient, use of green materials, naturalization, xeriscaping, alternate groundcovers, urban agriculture	10	8
Integrated Plan Contribution to urban & civic design and public green spaces above requirements: such as public art, streetscape, site furniture, fountains & innovation in concept & design	15	12.5
Maintenance Quality Adequate ongoing life cycle management (ongoing maintenance, ground & asset management, rehabilitation & replacement) of all landscape elements	10	8
Residential		
Streetscape Appeal Residential yards (year-round, seasonal, themed)	15	14
Maintenance Quality Lawn care, trees and shrub maintenance (with demonstrated results)	15	14
Plant Selection Selection of plant material (native, local, innovative, edible & pollinator friendly plants)	10	9
Community Involvement		
Public Participation in community programs (including children/youth) such as: urban agriculture, community gardens, "yard of the week", volunteer park maintenance, holiday illumination and decoration (promotion, organization, etc.)	20	18
Volunteer Succession Plan and Recognition Succession Plan and Recognition (by municipality and/or volunteer groups) of volunteer efforts in all aspects of the Communities in Bloom program including activities in all evaluated criteria	20	18
Landscape Total	200.00	179.50

2022 Evaluation Form

LANDSCAPE

Observations:

We observed how Barrie has set a high standard throughout the community and there is still a lot of opportunity for increased green infrastructure. Your main entrance sign on Hwy.400 is a great example of this.

You are setting a fine example in and around your municipal buildings ie. Town Hall and waterfront areas are a site to behold, with the business community slowly getting on board.

It is refreshing to see the incorporation of landscape elements to enhance spaces where people actively gather.

The residents of Barrie are planting a wide variety of annuals, perennials, shrubs and trees and maintaining their properties to a high standard.

Your Cenotaph Square and performance stage leading to the Waterfront with its indigenous interpretation is very impressive. Well done!!

Recommendations:

Council should be encouraged to develop an incremental progressive policy of growth of green infrastructure that includes current and existing installations in the city as well as future plans.

Develop plans for turning Dunlop Street into a pedestrian mall during snow free months.

Consider installing ephemeral plants with the anticipation of leaving all the structures you can during the winter.

Strategize how the importance of green infrastructure can be presented to the new incoming Council with the goal of having green infrastructure as a Strategic Priority for Barrie.

Driving back to town from the local airport, there is a cemetery on the right-hand side (that we drove by too fast for us to get its name). Review the need for a chain link fence around this property. The fence is rusting, and we fail to see any purpose for it. Recommendation is to remove with the hope of making the cemetery more inviting.

2022 Evaluation Form

PLANT AND FLORAL DISPLAYS		
<p>This category evaluates the efforts of the municipality, businesses, institutions and residents to design, plan, execute, and maintain plant and floral displays of high-quality standards. Evaluation includes the design and arrangements of flowers and plants (annuals, perennials, bulbs, ornamental grasses, edible plants, water efficient and pollinator friendly plants) in the context of originality, distribution, location, diversity and balance, colour, and harmony. It also pertains to flowerbeds, carpet bedding, containers, baskets and window boxes.</p>		
	Max	Actual
Municipal		
Floral Display Plan of Action Integration into overall landscape plan and distribution through community. Concept and design including sustainable design	15	14
Diversity of Displays Flowerbeds, raised beds, planters, hanging baskets, window boxes, carpet bedding, mosaics	20	19
Diversity of Plants Annuals, perennials, bulbs, grasses, woody plants, natural flora, pollinator friendly plants	10	9
Maintenance Quality Maintenance to appropriate specifications and standards, best practices: watering, weeding, edging, dead heading, etc.	20	19
Qualified Resources Qualified personnel (including seasonal staff) and/or in place training programs and/or qualified experienced contractors	10	9
Business & Institutions		
Design Concept and design (including arrangement, diversity, colour of display and plants) on grounds	15	13
Overall Plan Contribution to, and integration with, overall community plant and floral program	10	8
Maintenance Quality of planting and maintenance: watering, weeding, edging, dead heading, etc. with demonstrated results.	10	8
Residential		
Concept and Design (including arrangement, diversity, colour of display and plants) on residential properties including Pollinator gardens and/or inclusion of pollinator plants in gardens	20	19
Maintenance Quality of planting and maintenance with demonstrated results.	15	14
Community Involvement		
Public Participation in community projects, volunteer initiatives (including children/youth), outreach programs in plant and floral displays (including promotion, organization, etc.)	15	15
Community Support Financial and/or in-kind or participation by the municipality, businesses and institutions for community plant and floral displays activities	15	15
Plant and Floral Displays Total	175.00	162.00

2022 Evaluation Form

PLANT AND FLORAL DISPLAYS

Observations:

Barrie has great floral designed beds widely distributed through the community. The Town Hall, Waterfront and in parks to name just a few places, are being planted and maintained at a very high standard indeed. Well done.

The quality of plants is excellent, and a pleasant assortment only achieved by growing your own plants.

Your educational programs offered to volunteers has a positive effect on building an understanding of the importance of horticulture to the community as well as for personal wellbeing.

The floral hanging baskets and planters the municipality provides are complemented by the window boxes and planters that the business community is doing.

Those who are responsible for the plantings have created one of the best floral displays we have ever seen! Congratulations, and well done; you do great work.

Recommendations:

Develop a strategy for themes to celebrate with flowers, like roses for women on International Women's Day.

Think or question how plants could be used in some places rather than simply concrete. Find spots to plant. Bring plants closer to people so they touch and smell wherever they go.

Barrie might think about an experimental tree area for espalier growing using Linden, similar to what is being done in this photo . It would be fun.



Create box Linden, where Linden trees are pruned square at a certain height above the ground to accentuate form and encourage corporate businesses to express themselves in new ways.

2022 Evaluation Form

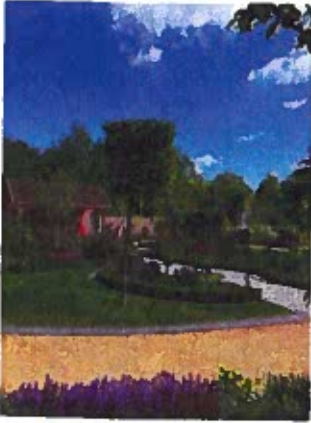

Develop a QR code system for identifying flowers, trees and stories and volunteers.

Barrie might consider using photos of garden trials (University of Guelph, Ball Seed company, Sawaya garden trials) to help educate staff, volunteers, and the public about what's new and upcoming in flowers for next year.

2022 Evaluation Form

2022 Evaluation Form



THANK YOU FOR YOUR INVOLVEMENT

“Within the context of climate change and environmental concerns, communities involved in the Communities in Bloom program can be proud of their efforts, which provide real and meaningful environmental solutions and benefit all of society.”

COMMUNITIES IN BLOOM IS MADE POSSIBLE BY

The commitment of local, provincial and national volunteers

The support of elected officials and of staff in municipalities

The dedication of our judges, staff and organizations

The contributions of our sponsors and partners